

28TH BOARD OF REPRESENTATIVES CITY OF STAMFORD

President
RANDALL M. SKIGEN
Clerk of the Board
ANNIE M. SUMMERVILLE

Majority Leader
ELAINE MITCHELL
Minority Leader
ROBERT "GABE" DELUCA



RESOLUTION NUMBER 3603
NOTICE OF INTENT TO DISCONTINUE
WATERSIDE PLACE
STAMFORD, CONNECTICUT

INSTR # 2013018967
VOL 10834 PG 114
RECORDED 08/23/2013 11:59:17 AM
DONNA M LOGLISCI
CITY & TOWN CLERK STAMFORD CT
BLOCK

WHEREAS, pursuant to the provisions of Section C8-60-1 of the Charter of the City of Stamford and Section 214-40 of the Stamford Code of Ordinances, the Board of Representatives of the City of Stamford is contemplating the discontinuance of Waterside Place & an Unnamed Highway, Stamford, Connecticut, more specifically depicted in the attached plan entitled "Map Depicting Discontinuance of Waterside Place From Pulaski Street to Davenport Street and an Unnamed Highway Connecting Greenwich Avenue and Waterside Place;" prepared by Edward J. Frattaroli, Inc. and dated July 2, 2013 ("Exhibit A") and which are owned by the City of Stamford; and;

WHEREAS, Waterside Place & an Unnamed Highway, which the Board of Representatives is contemplating discontinuing, begins at land owned by the City of Stamford comprising what is Davenport Street and continues to additional land owned by the City of Stamford comprising what is Pulaski Street in said City of Stamford. The total area of Waterside Place & Unnamed Highway is 18,280.35 square feet (.42 acres) as depicted on Exhibit A and further described in area, length and width on the attached property descriptions, entitled, "Property Description – Discontinuance of Waterside Place and Unnamed Highway" prepared by Edward J. Frattaroli, Inc. and dated July 2, 2013 ("Exhibit B").

NOW THEREFORE, BE IT RESOLVED BY THE 28th BOARD OF REPRESENTATIVES OF THE CITY OF STAMFORD THAT:

The public health, safety and welfare, convenience and necessity may require the discontinuation of Waterside Place as shown in Exhibit A; and

Pursuant to the provisions of Section C8-60-3 of the Charter of said City of Stamford, the Mayor is hereby requested to cause a report to be made on the contemplated discontinuance of Waterside Place as is more particularly described hereinabove and shown on said Exhibit A.

This resolution was approved on the Consent Agenda at the regular monthly meeting of the 28th Board of Representatives held on Monday, August 5, 2013.

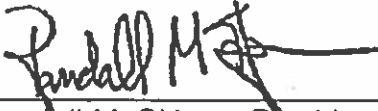

Randall M. Skigen, President



Annie M. Summerville, Clerk

- cc: Mayor Michael A. Pavia
Michael Handler, Director of Administration
Ernie Orgera, Chair, WPCA & Director of Operations
Ted Jankowski, Director of Public Safety
Joseph Capalbo, Esq., Director of Legal Affairs
Donna Loglisci, City & Town Clerk

EDWARD J. FRATTAROLI, INC.

Land Surveyors • Engineers • Land Planners



JOHN E. PUGLIESI, P.E., CT, NJ, NY & PA
KENNETH E. FRATTAROLI, L.S., CT, NY
ROBERT K. BULLARD, L.S.

62 MILL RIVER STREET • STAMFORD, CT 06902

Phone (203) 359-2235 • Fax (203) 324-5291

www.frattaroli.com



EDWARD J. FRATTAROLI, 1907-1993
PAUL G. KOTOSKY, 1931-2001
RICHARD E. FRATTAROLI, L.S. (RETIRED)
JOSEPH J. FRATTAROLI (RETIRED)

PROPERTY DESCRIPTION – DISCONTINUANCE OF WATERSIDE PLACE AND UNNAMED “HIGHWAY”

Beginning at a point on the easterly side of Davenport Street where the same intersects the southerly side of Waterside Place; thence running northerly along the easterly side of Davenport Street N 05°42'19" E a distance of 35.32 feet to the Northerly Side of Waterside Place; thence running easterly along the northerly side of Waterside Place S 73°05'56" E a distance of 118.61 feet to the westerly side of an unnamed “Highway”; thence running northerly along the westerly side of said unnamed “Highway” N 03°59'35" E a distance of 100.06 feet to the southerly side of Greenwich Avenue; thence running easterly along the southerly side of Greenwich Avenue N 79°06'59" E a distance of 33.23 feet to the easterly side of an unnamed “Highway”; thence running southerly and easterly along the easterly, northerly and southerly sides of said unnamed “Highway” and Waterside Place along a non-tangential curve turning to the left with a delta angle of 33°29'11", a radius of 25.43', an arc length of 14.86', a chord bearing of S 24°22'07" W, and a chord length of 14.66'; thence S 07°37'50" W a distance of 68.32 feet; thence S 04°30'10" E a distance of 20.60 feet; thence S 23°10'10" E a distance of 20.00 feet; thence S 41°20'10" E a distance of 21.00 feet; thence S 55°08'10" E a distance of 36.60 feet; thence S 67°22'10" E a distance of 8.27 feet; thence S 82°48'10" E a distance of 47.00 feet; thence N 22°46'50" E a distance of 94.80 feet; thence N 15°33'50" E a distance of 76.30 feet to the southerly side of Pulaski Street; thence running along the southerly side of Pulaski Street S 78°52'09" E a distance of 25.44 feet to the easterly side of Waterside Place; thence running southerly and westerly along Waterside Place the following courses and distances S 15°35'35" W a distance of 220.794 feet; thence N 69°36'50" W a distance of 295.76 feet; to the point or place of beginning.

The above described tract of land contains 18280.35 square feet or 0.420 acres.

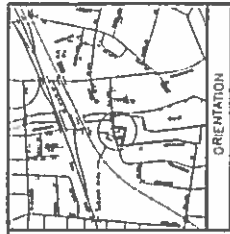

ORIENTATION

Sheet No. 25 & 32

MAP DEPICTING DISCONTINUANCE OF WATERSIDE PLACE FROM PULASKI STREET TO DAVENPORT STREET AND AN UNNAMED "HIGHWAY" PREPARED FOR THE CITY OF STAMFORD, CONNECTICUT

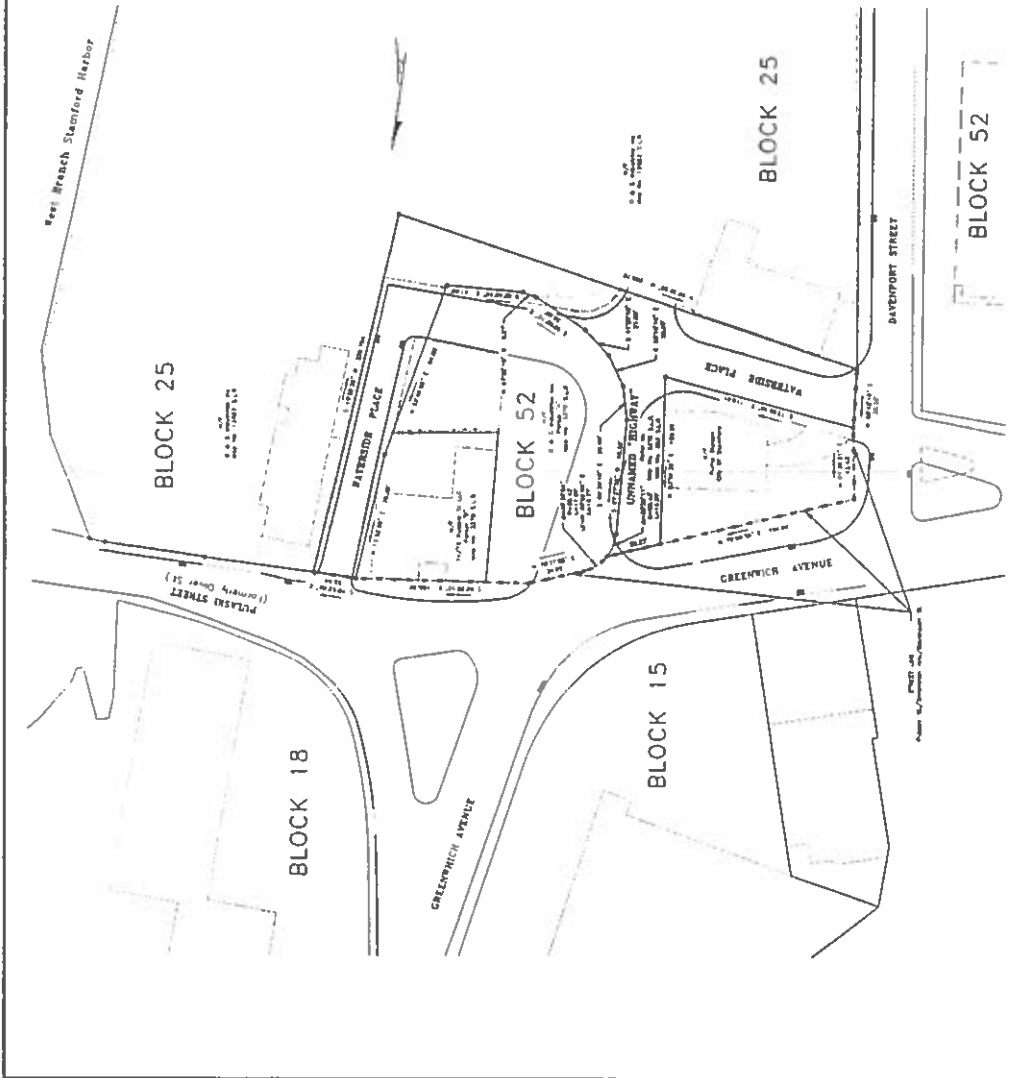

The Survey and Map were prepared by the Surveyors and Engineers, 18-200-111, City of Stamford, CT, in accordance with the provisions of the Connecticut General Statutes, Chapter 280a, and the provisions of the Connecticut General Statutes, Chapter 280a-111, and the provisions of the Connecticut General Statutes, Chapter 280a-111, and the provisions of the Connecticut General Statutes, Chapter 280a-111.

Prepared by: **DR. JAMES A. CALVERT, INC.**
 1000 Westchester Avenue, Stamford, Connecticut 06907
 Phone: (203) 338-1111

Approved for Submission and Filing:
 Date: _____
 For: City of Stamford

Area of Representation: 0.13033 Sq. Ft.
 Scale: 1" = 30'